

## WZC (P) type thermal resistance



### ◇ Overview said

WZC ( P ) type thermal resistance is used as a temperature measuring sensor. It is usually used to match the display instrument to directly measure the surface temperature of liquid, vapor and gas medium and solid in various production processes. The exterior is made of stainless steel.

### ◇ Characteristics and working principle

Thermal resistance is the measurement of temperature by the nature of the material as it changes in temperature. The heated part of the thermal resistor (temperature sensing element) is

uniformly wound with a thin wire on a skeleton made of an insulating material. When a temperature gradient exists in the measured medium, the measured temperature is the range of the temperature sensing element. The average temperature in the inner dielectric layer.

### ◇ 外形及安装尺寸

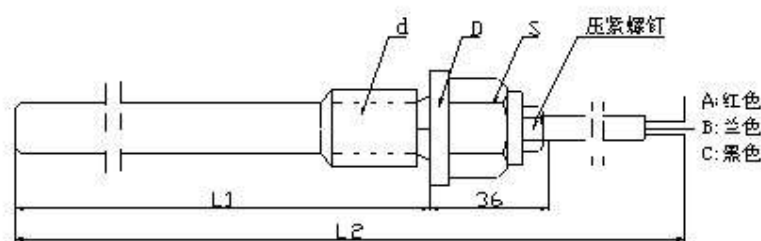

### ◇ 型号说明

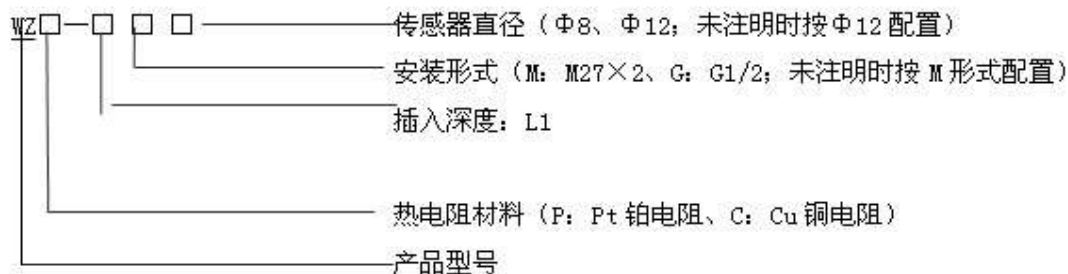

(例: WZC50-150MΦ6 表示: 铜热电阻、阻值为 50、安装形式为 M27×2、插入深度 150mm、传感头直径 Φ12。用户在有特殊需求时应在订货时注明)